

# Let's get started.

Need help? Scan the QR code for video tutorials and user guide.



*[link.gl-inet.com/rm10rc-userguide-support](https://link.gl-inet.com/rm10rc-userguide-support)*

**GL·iNet**

**GL-RM10RC / Comet 5G  
Remote KVM**

# PRODUCT INTERFACE DESCRIPTION

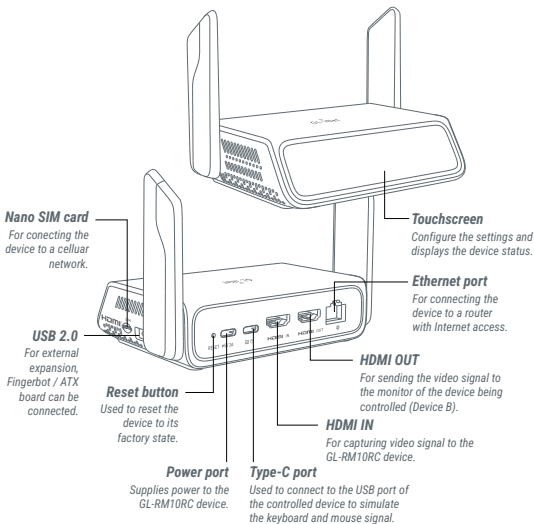

# SUPPORT

## Technical Support

- For more detailed instructions, please visit our website [link.gl-inet.com/rm10rc-userguide-support](https://link.gl-inet.com/rm10rc-userguide-support)
- For further questions, contact us via these methods:
  - Email: [support@gl-inet.com](mailto:support@gl-inet.com)
  - Discord: [link.gl-inet.com/website-discord-support](https://link.gl-inet.com/website-discord-support)
  - Reddit: [link.gl-inet.com/website-reddit-support](https://link.gl-inet.com/website-reddit-support)
  - Forum: [forum.gl-inet.com](https://forum.gl-inet.com)

# TROUBLESHOOTING

## Reset

- Press and hold the Reset button for **8 seconds** to restore factory settings.

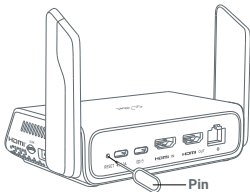

## Remote Mouse Cursor Misalignment

- If the mouse cursor on the controlled computer isn't appearing in the same position on your screen, adjust the computer's display resolution to one of the supported options listed below.

**60FPS Support:** 2560x1440, 1920x1200, 1920x1080, 1600x1200, 1440x900, 1360x768, 1280x1024, 1280x800, 1280x720, 1024x768, 800x600.

**30FPS Support:** 3840x2160.

## 5G Internet Access Issue

- If the GL-RM10RC establishes a 5G cellular connection but fails to access the Internet, verify if the SIM card has exceeded its data allowance, or try to check the Cellular setting on the web. If can't solve the issue please contact our support team.

# WARRANTY

- We provide ***two-year limited warranty*** for remote KVM and ***3-month limited warranty*** for accessories
- Extra warranty may apply according to the local law in which the product purchase took place.
- Highly recommend using the **5V/3A** power adapter in the package.
- Any damage to the device caused by not following the instructions will render this warranty null and void.
- Any damage to the device caused by modifying the PCBA, components or case will render this warranty null and void.
- Issues caused by the use of third-party firmware may not get official support from us.
- Any damage to the device caused by inappropriate use, e.g. inappropriate voltage input, high temperature, dropping in the water or on the ground will render this warranty null and void.
- Pictures on the instructions are only for reference. We reserve the right to change or modify these materials without prior notice.

# FCC ID: 2AFIW-RM10RC

## Warning

To assure continued compliance, any changes or modifications not expressly approved by the party responsible for compliance could void the user's authority to operate this equipment.

## FCC Statement

This device complies with Part 15 of the FCC Rules. Operation is subject to the following two conditions:

- (1) this device may not cause harmful interference, and
- (2) this device must accept any interference received, including interference that may cause undesired operation.

NOTE: This equipment has been tested and found to comply with the limits for a Class B digital device, pursuant to part 15 of the FCC rules. These limits are designed to provide reasonable protection against harmful interference in a residential installation. This equipment generates, uses and can radiate radio frequency energy and, if not installed and used in accordance with the instructions, may cause harmful interference to radio communications.

However, there is no guarantee that interference will not occur in a particular installation. If this equipment does cause harmful interference to radio or television reception, which can be determined by turning the equipment off and on, the user is encouraged to try to correct the interference by one or more of the following measures:

- Reorient or relocate the receiving antenna.
- Increase the separation between the equipment and receiver.
- Connect the equipment into an outlet on a circuit different from that to which the receiver is connected.
- Consult the dealer or an experienced radio/TV technician for help.

## IC Caution:

This device complies with Innovation, Science, and Economic Development Canada licence-exempt RSS standard(s).

Operation is subject to the following two conditions:

- (1) this device may not cause interference, and
- (2) this device must accept any interference, including interference that may cause undesired operation of the device.

Le présent appareil est conforme aux CNR d'Innovation, Sciences et Développement économique Canada applicables aux appareils radio exempts de licence. L'exploitation est autorisée aux deux conditions suivantes:

- (1) l'appareil ne doit pas produire de brouillage, et
- (2) l'utilisateur de l'appareil doit accepter tout brouillage radioélectrique subi, même si le brouillage est susceptible d'en compromettre le fonctionnement.

The user manual for LE-LAN devices shall contain instructions related to the restrictions mentioned in the above sections, namely that:

- the device for operation in the band 5150-5250 MHz is only for indoor use to reduce the potential for harmful interference to co-channel mobile satellite systems;
- le dispositif utilisé dans la bande 5150-5250 MHz est réservé à une utilisation en intérieur afin de réduire le risque de brouillage préjudiciable aux systèmes mobiles par satellite dans le même canal.

## FCC/IC Radiation Exposure Statement:

The equipment complies with FCC Radiation exposure limits set forth for uncontrolled environment. This equipment should be installed and operated with minimum distance 20cm between the radiator and your body.

L'appareil est conforme aux limites d'exposition aux rayonnements spécifiées par la FCC/ISED pour les environnements non contrôlés. La distance entre le radiateur et le corps doit être d'au moins 20 cm lors de l'installation et du fonctionnement de l'appareil.

Frequency band: 5150 - 5250 MHz:

Indoor use: Inside buildings only. Installations and use inside road vehicles and train carriages are not permitted. Limited outdoor use: If used outdoors, equipment shall not be attached to a fixed installation or to the external body of road vehicles, a fixed infrastructure or a fixed outdoor antenna. Use by unmanned aircraft systems (UAS) is limited to within the 5170 - 5250 MHz band.

Frequency band: 5250 - 5350 MHz:

Indoor use: Inside buildings only. Installations and use in road vehicles, trains and aircraft are not permitted. Outdoor use is not permitted.

Frequency band: 5470 - 5725 MHz:

Installations and use in road vehicles, trains and aircraft and use for unmanned aircraft systems (UAS) are not permitted.

	AT	BE	BG	HR	CY	CZ	DK	EE	FI	FR	DE	EL	HU	IS	IE	IT
	LV	LI	LT	LU	MT	NO	PL	PT	RO	SK	SI	ES	SE	CH	NL	UK(NI)

#### Declaration of conformity

Hereby, GL TECHNOLOGIES (HONG KONG) LIMITED declares that the radio equipment type [Remote KVM, GL-RM10RC] is in compliance with Directive 2014/53/EU. The full text of the EU declaration of conformity is available at the following internet address:

<https://www.gl-inet.com/products/certificate>.

#### Wi-Fi Transmission Power:

FCC:  $\leq 30\text{dBm}$  (2.4 GHz),  $\leq 30\text{dBm}$  (5 GHz)

CE:  $\leq 20\text{dBm}$  EIRP (2.4GHz);  $\leq 23\text{dBm}$  EIRP (5.15GHz~5.35GHz);

$\leq 30\text{dBm}$  EIRP (5.47GHz~5.725GHz);  $\leq 13.98\text{dBm}$  (5.725GHz~5.85GHz)

Power supply: ICP20-050-3000D, For applicable power supplies see user instructions.

#### Hong Kong Office

GL Technologies (Hong Kong) Limited  
Unit 601, Building 5W, Hong Kong Science Park,  
Shatin, N.T., Hong Kong

#### Shenzhen Office

Shenzhen Guanglianzhitong Tech Co., Ltd.  
Room 305 - 306, Skyworth Digital Building, Shiyuan Street,  
Baoan District, Shenzhen, China, 518000  
(+86-0755-86606126)



# SETTING UP

## Device A



Controlling device

## Device B

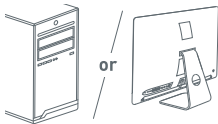

Device being controlled

1

Insert SIM card and connect the GL-RM10RC to a power source to power on.

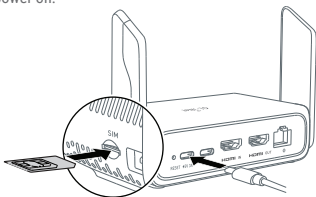

 Insert SIM card first

Plug in power cable

2

Use a **HDMI cable** to connect the GL-RM10RC's HDMI IN port to the HDMI port of Device B. Use **another HDMI cable** to connect the GL-RM10RC's HDMI OUT port to the monitor of Device B.

### Desktop Computer

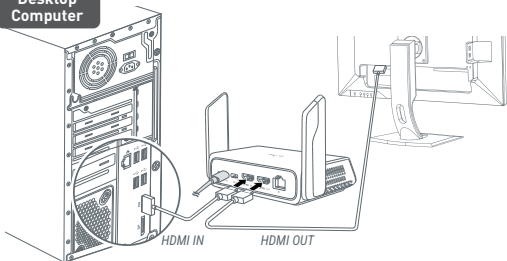

### All-in-one Computer

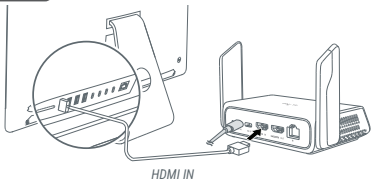

3

Connect the GL-RM10RC's Type-C port to the USB interface of the Device B using a **USB-C cable**.

**Desktop  
Computer**

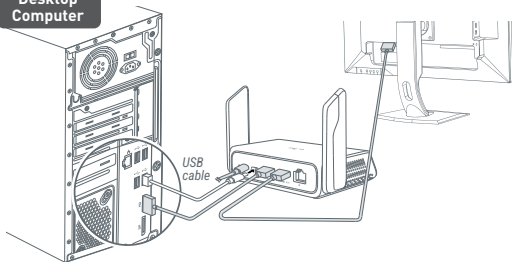

**All-in-one  
Computer**

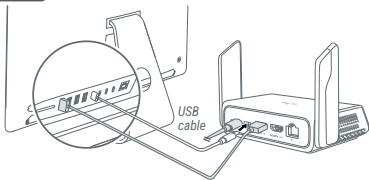

## 4

## Internet Connection

### **5G:**

Please ensure a SIM card is inserted. The 5G connection will automatically establish upon system startup.

(Note: The connection priority is Ethernet > Wi-Fi > 5G.)

### **Wi-Fi:**

Activate the GL-RM10RC's touchscreen, swipe left, and connect to an existing Wi-Fi network.

(Note: 2.4GHz and 5GHz are both supported)



### **Ethernet:**

Connect an Ethernet cable from a network source to the device's Ethernet port.

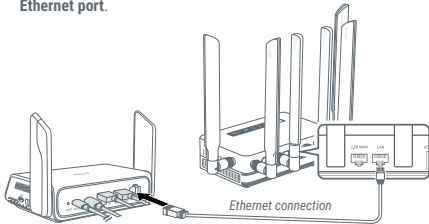

5

**Local access:**

Access the GL-RM10RC by visiting the IP address displayed on the touchscreen.

(Note: Only applicable when connected via Ethernet or Wi-Fi.)



**Nearby access:**

When you are in close proximity to the GL-RM10RC, enable "AP Mode" in the Wi-Fi settings. Connect Device A to its hotspot and access via the default IP address (**192.168.8.1**) in a web browser.

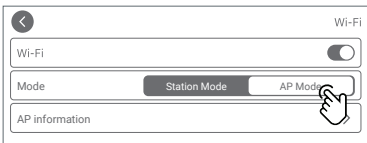

**Remote access:**

For remote access, visit ***www.glkvm.com*** in a web browser to bind your device online.



## **APP:**

Download and install the application from

**<https://www.gli-net.com/app-rm/>** onto Device A. Follow the on-screen instructions to register an account and bind your GL-RM10RC.

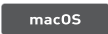

**Scan to download**



**<https://www.gli-net.com/app-rm/>**