

# Let's get started.

Need help? Scan the QR code for video tutorials and user guide.



*[link.gl-inet.com/rm1pe-userguide-support](http://link.gl-inet.com/rm1pe-userguide-support)*

**GL·iNet**

**GL-RM1PE / Comet PoE  
Remote KVM**



# PRODUCT INTERFACE DESCRIPTION

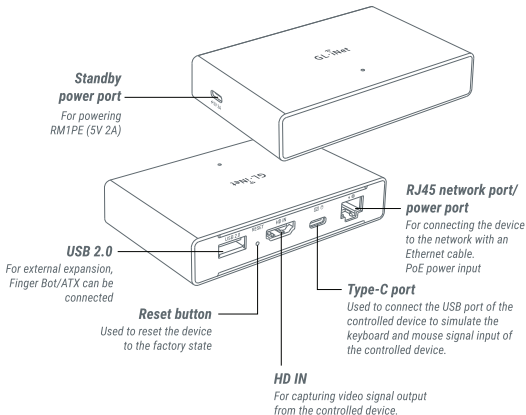



# SUPPORT

## Technical Support

- For more detailed and updated instructions, please visit our website  
*[https://docs.gl-inet.com/kvm/en/user\\_guide/](https://docs.gl-inet.com/kvm/en/user_guide/)*
- For further questions, contact us via these methods:
  - Email: *[support@gl-inet.com](mailto:support@gl-inet.com)*
  - Discord: *[link.gl-inet.com/website-discord-support](https://link.gl-inet.com/website-discord-support)*
  - Reddit: *[link.gl-inet.com/website-reddit-support](https://link.gl-inet.com/website-reddit-support)*
  - Forum: *[forum.gl-inet.com](https://forum.gl-inet.com)*



# TROUBLESHOOTING



## Repair / Reset

- Press and hold the Reset button for **8 seconds** to restore factory settings.

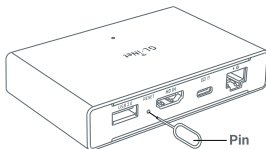

## Remote Mouse Cursor Misalignment

- If the mouse cursor on the controlled computer isn't appearing in the same position on your screen, adjust the computer's display resolution to one of the supported options listed below.

**60FPS Support:** 2560x1440, 1920x1200, 1920x1080, 1600x1200, 1440x900, 1360x768, 1280x1024, 1280x800, 1280x720, 1024x768, 800x600.

**30FPS Support:** 3840x2160.



# SETTING UP

## Device A



Controlling device

## Device B

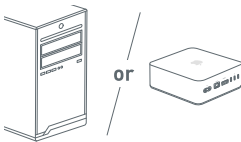

Device being controlled



1

Connect the GL-RM1PE device to the PoE Switch with a network cable.

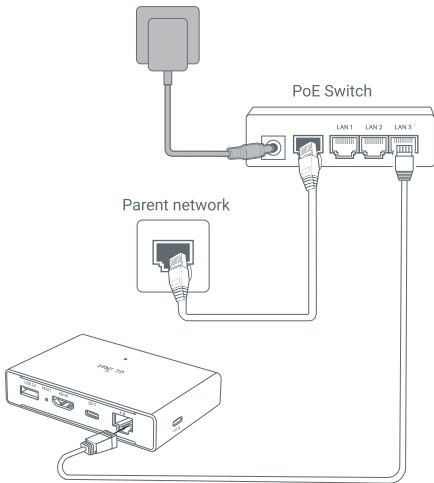



2

Connect the controlled host and the GL-RM1PE device with an HD cable.

Windows

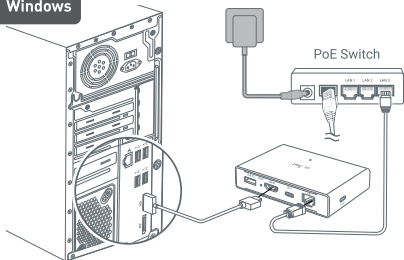

macOS

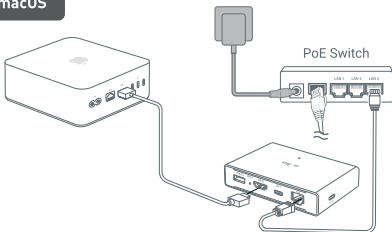



3

Connect the controlled host and the GL-RM1PE device with the USB cable.

Windows

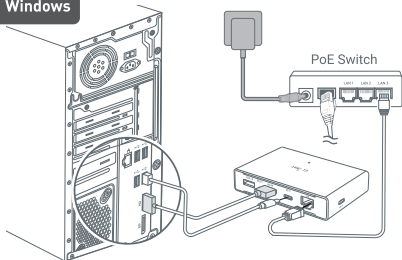

macOS

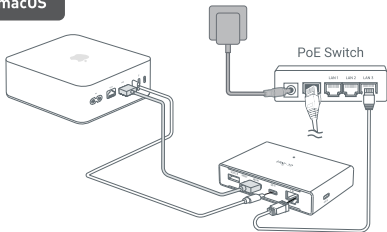



4

Visit <https://www.gli-net.com/app-rm/> to download and install the application on the Device A. Follow the on-screen instructions to register an account and bind your GL-RM1PE.

 Windows macOS



# WARRANTY

- We provide **two-year limited warranty** for routers and **3-month limited warranty** for accessories
- Extra warranty may apply according to the local law in which the product purchase took place.
- Any damage to the device caused by not following the instructions will render this warranty null and void.
- Any damage to the device caused by modifying the PCBA, components or case will render this warranty null and void.
- Issues caused by the use of third-party firmware may not get official support from us.
- Any damage to the device caused by inappropriate use, e.g. inappropriate voltage input, high temperature, dropping in the water or on the ground will render this warranty null and void.
- Pictures on the instructions are only for reference. We reserve the right to change or modify these materials without further notice.

---

## FCC Statement

This device complies with Part 15 of the FCC Rules. Operation is subject to the following two conditions:

(1) this device may not cause harmful interference, and

(2) this device must accept any interference received, including interference that may cause undesired operation.

NOTE: This equipment has been tested and found to comply with the limits for a Class B digital device, pursuant to Part 15 of the FCC Rules. These limits are designed to provide reasonable protection against harmful interference in a residential installation

## Declaration of conformity

Hereby, GL TECHNOLOGIES (HONG KONG) LIMITED declares that this product type [Remote KVM, GL-RM1PE] is in compliance with the essential requirements and other relevant provisions of Directive 2014/30/EU and 2011/65/EU. The full text of the EU declaration of conformity is available at the following internet address:

<https://www.gl-inet.com/products/certificate>.

---

## Hong Kong Office

GL Technologies (Hong Kong) Limited  
Unit 601, Building 5W, Hong Kong Science Park,  
Shatin, N.T., Hong Kong

## Shenzhen Office

Shenzhen Guanglianzhitong Tech Co., Ltd.  
Room 305 - 306, Skyworth Digital Building, Shiyuan Street,  
Baoan District, Shenzhen, China, 518000  
(+86-0755-86606126 )

